

LUBRICANT	INTERVAL	AMOUNT
Dexron ATF or equivalent	Initial: After 100 hours Subsequent: 1,000 hours or every 6 months under normal operating conditions	½ Full (approximately 4 oz.)

LUBRICATION:

All gears are shipped lubricated. Ensure that lubrication has not leaked during shipping. If there are indications that lubrication has leaked:

Contact NIRECO America Corporation (845-856-4053) **IMMEDIATELY**. Do not mount and use gearbox until contacting manufacturer.

After the initial 100 hours of operation drain out initial oil, flush out the gearbox with an approved non-flammable, non-toxic solvent and refill. Thereafter, oil should be changed every 1,000 operating hours or every six months, whichever comes first. If gearbox is operating in extremely dirty or high or low temperature environment, change oil more often.

Lubrication procedure:

1. Remove the two (2) one-quarter (¼) npt pipe plugs and drain lubricant into a container.
2. Inspect the fluid for metal particles or other signs of excessive wear. If either is found, contact the manufacturer before replacing the gearbox.
3. Rotate the differential until one hole is horizontal. Add new fluid until the unit is one-half (½) full.
Note: The fluid must be added slowly or it may exit the horizontal hole prior to reaching the desired level.
4. Replace the pipe plugs.
5. Clean and run the unit to check for leaks.

INSTALLATION:

Because of varying requirements, mounting hardware is not supplied with units. Good quality cap screws with lock washers should always be used. Base and fasteners for gearboxes must be rigid enough to maintain alignment.

Alignment – When installing care should be taken to align input and output shafts with connecting shafts. Maintain concentricity within 0.002 TIR. Flexible couplings will help compensate for minor variations in shaft alignment.

Couplings – Flexible couplings to pinion and cross shafts are recommended because they minimize bearing and gear wear caused by slight misalignment. Follow coupling and manufacturer's installation directions.

Sheaves and sprockets - When mounting sheaves or sprockets, the center of the load should be located as close to the gearbox as possible. Excessive overhung loading could result in early failure of bearings. Refer to the general catalog or contact your local distributor for overhung load.

PREVENTATIVE MAINTENANCE:

Keep shafts and vent plug clean to prevent foreign particles from entering seals or gear case. Inspect periodically for oil leaks. Check couplings, setscrews and gearbox bolts for tightness (loose fasteners can cause alignment problems and excessive wear). Check endplay in shafts. Noticeable movement might indicate service or parts replacement.

PART ORDERING INFORMATION: When ordering parts, please provide model and serial number located on the gearbox nameplate along with item number and description of parts.

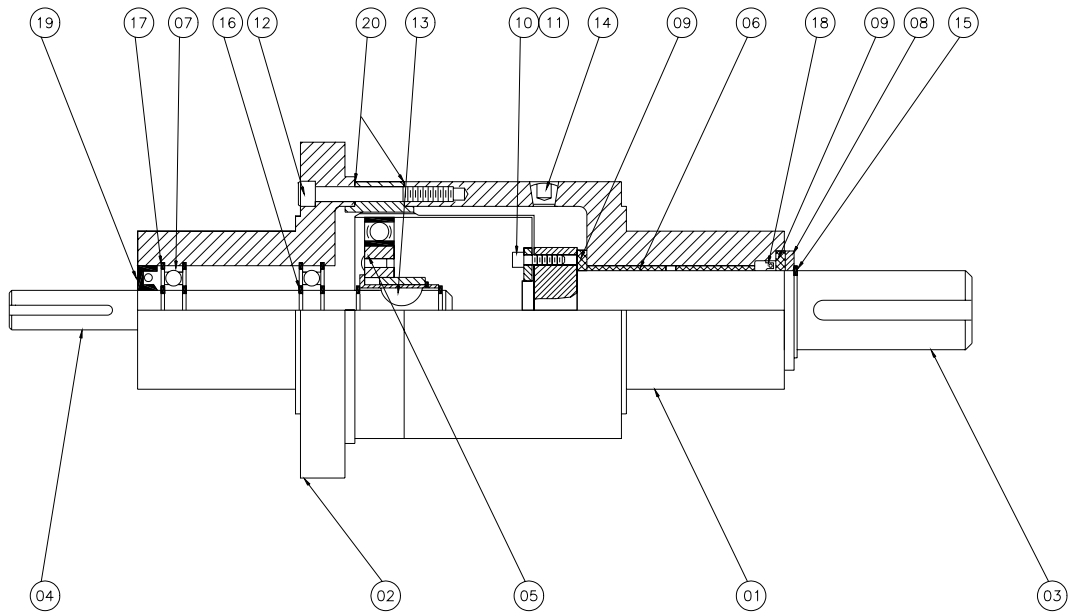

ITEM	QTY.	DESCRIPTION	ITEM	QTY.	DESCRIPTION
01	01	HOUSING, POWER	11	06	SCREW
02	01	HOUSING, TRIM	12	06	SCREW
03	01	SHAFT, POWER	13	01	KEY
04	01	SHAFT, TRIM	14	02	PIPE PLUG
05	01	HD SYSTEM	15	01	RETAINING RING
06	02	BRONZE SLEEVE	16	06	RETAINING RING
07	02	BEARING	17	04	RETAINING RING
08	01	THRUST WASHER	18	01	SEAL
09	02	THRUST WASHER	19	01	SEAL
10	06	SCREW	20	02	GASKET